

Application : Central Locks

用途：中控鎖

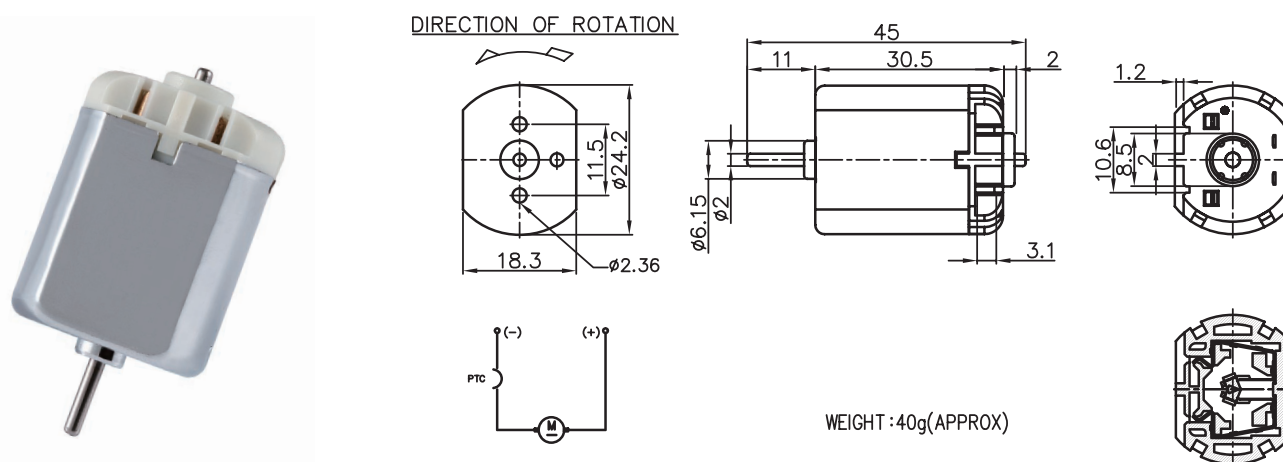

| MODEL | VOLTAGE | | NO LOAD | | AT MAXIMUM EFFICIENCY | | | | | | STALL | | |
|-------------------|-----------------|----------------|---------|---------|-----------------------|---------|--------|------|--------|-----|---------|--------|-------|
| | OPERATING RANGE | NOMNAL | SPEED | CURRENT | SPEED | CURRENT | TORQUE | | OUTPUT | EFF | CURRENT | TORQUE | |
| | | | rpm | A | rpm | A | g-cm | mN-m | W | % | A | g-cm | mN-m |
| DC-280ST-15265-NR | 12.0 – 24.0 | 24.0V CONSTANT | 14000 | 0.10 | 12361 | 0.41 | 52 | 5.10 | 6.54 | 69 | 2.34 | 360 | 35.29 |
| DC-280ST-18165P-R | 6.0 – 12.0 | 12.0V CONSTANT | 11500 | 0.14 | 10060 | 0.59 | 44 | 4.31 | 4.55 | 67 | 2.96 | 275 | 26.96 |
| DC-280ST-18180P-R | 6.0 – 12.0 | 12.0V CONSTANT | 10000 | 0.13 | 8299 | 0.51 | 47 | 4.61 | 4.01 | 67 | 2.42 | 271 | 26.57 |
| DC-280ST-20150P-R | 6.0 – 12.0 | 12.0V CONSTANT | 12500 | 0.16 | 10616 | 0.80 | 54 | 5.29 | 5.95 | 65 | 3.85 | 337 | 33.04 |

馬達的出軸長度及性能參數，EMC 對策可依客人要求做調整，詳情可詢問相關業務人員。
Please inquire your sales representative for output, performance and EMC solution.

