

NEW-FLOW

**ISO 9001
REGISTERED**

NEW-FLOW

Instruction Manual

PLASTIC RELIEF VALVES

RS SERIES



NEW-FLOW TECHNOLOGIES, INC.

No.9 Lane 133, Xing-Hua St., Chien Chen Dist., Kaohsiung 806, Taiwan

TEL: 886-7-8135500 FAX: 886-7-8225588 / 8159758

Email: info@new-flow.com www.new-flow.com

INSTALLATION

Technical Data

Back pressure relief valves

Large flow rate

Material: Body-P.V.C, P.P, PVDF; Diaphragm membrane -Viton + Teflon Plate

Inlet pressure: maximum 1.035Mpa (150psi)

Adjustable range: 0.035~0.7Mpa (5~100 psi)

Working temp.: 60°C

Working fluid: Water corrosive liquid

Panel mounting available

Mounting type: Straightened on pipe line

Type	Connection Size (Female)	CV
RS-10	¼"NPT	1.0
RS-15	½"NPT	2.0
RS-20	¾"NPT	2.5
RS-25	1"NPT	3.5
RS-40	1½"NPT	4.5
RS-50	2"NPT	5.5

*Option: BSP type available

Range Table

Code	Range
05R	5~50 PSI
50R	50~112 PSI

Dimensions

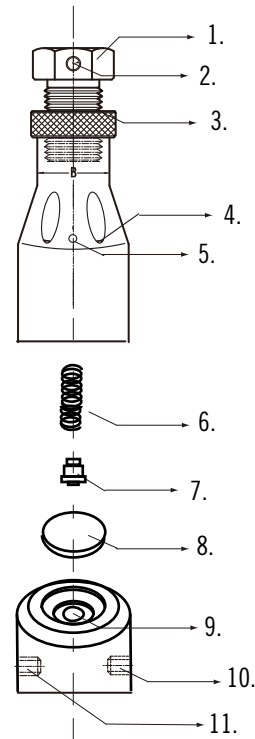
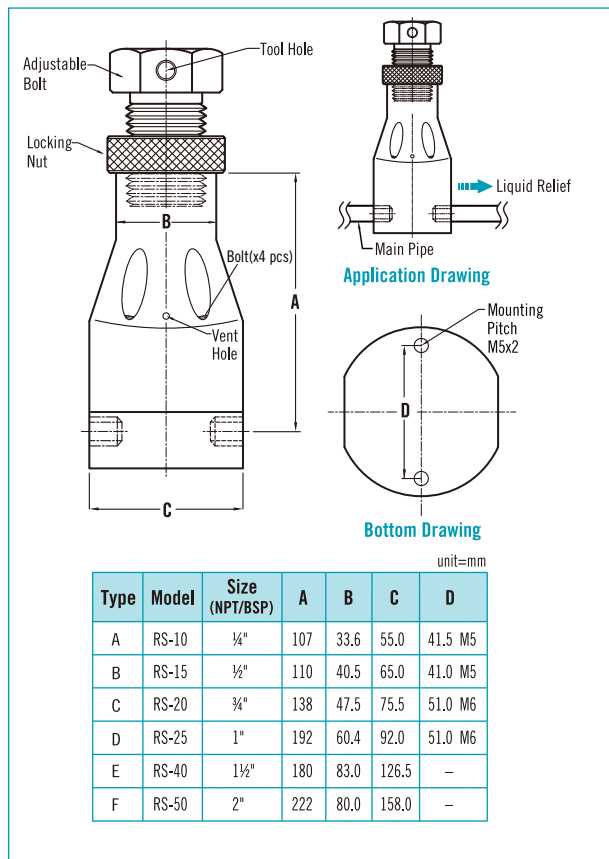

Parts List

Item	Parts Name	Material	Q'ty
1.	Adjustable Bolt	C.S	1 pc
2.	Tool Hole	Plastic	1 pc
3.	Locking Nuts	Plastic	1 pc
4.	Bolt(x4 pcs)	C.S	1 pc
5.	Vent Hole	P.V.C, P.P, PVDF available	1 pc
6.	Spring	C.S	1 pc
7.	Spring Support	P.V.C	1 pc
8.	Diaphragm	Viton+Teflon Plate	1 pc
9.	Valve Seat	P.V.C, P.P, PVDF available	1 pc
10.	Outlet Port	P.V.C, P.P, PVDF available	1 pc
11.	Inlet Port	P.V.C, P.P, PVDF available	1 pc

Installation Instruction

- 1.The Series RS-Series relief valve was designed to keep safe for tank, piping and pump when process liquid flow over pressure in these system.
- 2.Its function was designed as the pressure is reached the set point, valve will open slowly, when the pressure drops, valve seat will close slowly. Meanwhile the pressure lower than set pressure.
- 3.Don't attach this valve to metal thread to avoid plastic thread damage. To be avoid valve broken.
- 4.Don't use much force to tight bolt and to tight inlet or outlet threads.
- 5.Please clean inner face of pipe of inlet and outlet