

MINI WARNING LAMP

- ◆ High Brightness LED Warning Strobes
- ◆ Fully Sealed to IP 67 Standard
- ◆ Effective for Warning others of Working Vehicle
- ◆ **ECE R65** Approved Lighting



Z-W03 Series LED Warning Lamp



Item No.	Z-W03
LED color	● ● ●
LED Q'TY (PCS)	3
SMD	3535
Input Voltage	12-24V
Power Consumption (W)	
Modes	4 modes flash
Function	"X" Warning
Compliance	SAE J595 ECE R65 R10

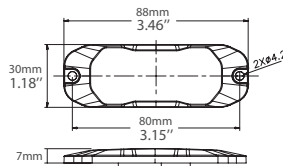

Z-W04 Series LED Warning Lamp



Item No.	Z-W03
LED color	● ● ●
LED Q'TY (PCS)	6
SMD	3535
Input Voltage	12-24V
Power Consumption (W)	
Modes	8 modes flash
Function	"X" Warning
Compliance	SAE J595 ECE R65 R10

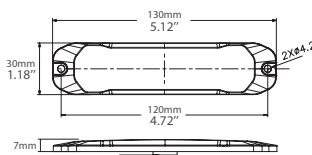

YTK CO.,LTD.
[Http://www.ytk-group.co.jp](http://www.ytk-group.co.jp)

Z-W00 Series LED Warning Lamp



Item No.	Z-W001	Z-W002	Z-W003	Z-W004
LED color	●	●	○	●
LED Q'TY (PCS)	4			
SMD	3535			
Input Voltage	12-24V			
Power Consumption (W)	12			
Modes	4 modes flash			
Function	"X" Warning			
Compliance	SAE J595 ECE R65 R10			

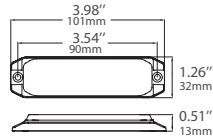

Z-W01 Series LED Warning Lamp



Item No.	Z-W011	Z-W012	Z-W013	Z-W014
LED color	●	●	○	●
LED Q'TY (PCS)	6			
SMD	3535			
Input Voltage	12-24V			
Power Consumption (W)	18			
Modes	4 modes flash			
Function	"X" Warning			
Compliance	SAE J595 ECE R65 R10			

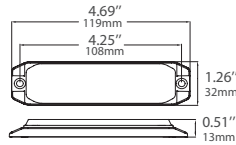

Z-W05 Series LED Warning Lamp



Item No.	Z-W051	Z-W052	Z-W053	Z-W054
LED color	●	●	○	●
LED Q'TY (PCS)	9			
SMD	3535			
Input Voltage	12-24V			
Power Consumption (W)	27			
Modes	10 modes flash			
Function	"X" Warning			
Compliance	SAE J595 ECE R65 R10			

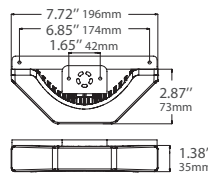

Z-W24 Half moon warning light



Item No.	Z-W24
LED color	●
LED Q'TY (PCS)	6
SMD	2525
Input Voltage	12-24V
Power Consumption (W)	18
Modes	10 modes flash + 1 mode-Steady on
Function	"X" Warning
Compliance	SAE J595 ECE R65 TA2 R10

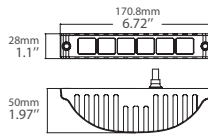

Z-W29 Warning lamp with side marker



Item No.	Z-W29
Input Voltage	12-24V
Power Consumption (W)	0.5W(SDMK) / 10W(Warning)
Current / Voltage	0.02A/0.42A @ 24V
Lens Material	PC
LED Q'TY (PCS)	12
LED color	●
Function	Marker / Warning
Compliance	ECE R91 R10

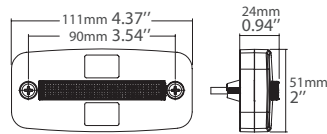

Z-W385 Series 2-in-1 Warning Lights (Warning Light+Position Light)



Ordinary Type



Chrome Type

Beam Pattern	Warning Light	Position Light
Power Consumption (W)	11.5	1.6
Current / Voltage	0.67A @ 24V	0.67A @ 24V
LED Q'TY (PCS)	12	2
SMD	3030	3030
Input Voltage	12-24V	
LED color	● ○	
Lighting	5 modes flash + Position light	
Compliance	CISPR 25 SAE J845 CLASS 1 ECE R65 R10	

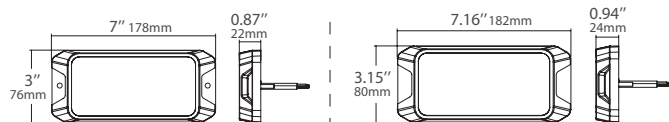

MAGNETIC MINI WARNING BAR

MINI warning bar with a rectangle classic shape but a innovation refector .
Single refector and dual refector in options with amber and transparent cover optional .
Mini size makes it a wide range application for all emergency situation usage.
Strong magnetic base to hold tight when driving .With over-charge ,over-discharge protect .
ECE R65 ,SAE J845 will be certified



Flash modes



Rotation modes



Introduce

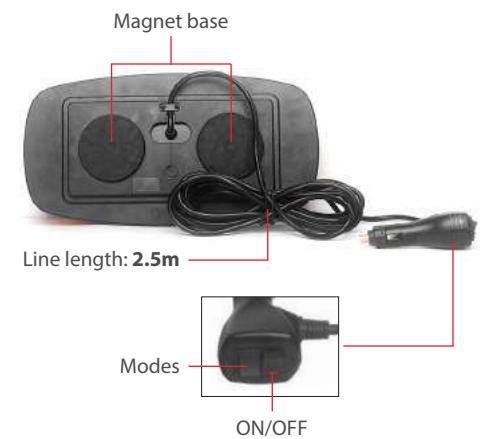

Z-W12B Rechargeable Mini Warning Bar



Item No.	Z-W12B
Input Voltage	12-24V
Power Consumption	38
Current	1.35A
SMD	2835
LED Q'TY	84
LED color	● ● ●
Modes	5 modes flash + 2 modes rotation
Compliance	SAE J845 ECE R65 R10

Charging time
About 4.5H

Discharging time
About 6.5H

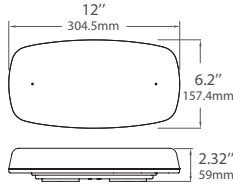

Charging interface	DC 5.5/2.1
Electric core	2 * Double section 18650 lithium ion
Capacity	2 * 7.4V 2600mAh (38.5WH)
Charging voltage	12V/24V
Charging current	1400mA (12V) / 700mA (24V)
Charging time	About 4.5H
Discharging time	About 6.5H



Z-W12D / Z-W12M Magnetic Mini Warning Bar



Item No.	Z-W12D	Z-W12M
Input Voltage	12V/24V	12V/24V
Power Consumption (W)	35	34(SAE) / 38(ECE)
LED Q'TY (PCS)	20	84
SMD	2535	2835
LED color	● ● ●	
Current	1.35-1.45A	
Modes	3 modes flash + 4 modes rotation (Z-W12D)	
	5 modes flash + 2 modes rotation (Z-W12M)	
Compliance	SAE J845 ECE R65 R10	

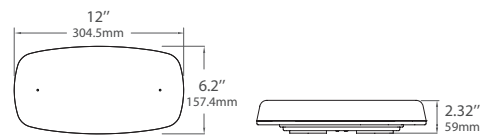

Z-W26 Series Super Slim Minibar



Red+Blue
Light



Z-W26S - Screw mount



Z-W26M - Magnetic mount

Amber
Light



Z-W26S - Screw mount

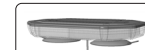

Z-W26M - Magnetic mount

Item No.	Z-W26S	Z-W26M
Input Voltage	12-24V	12-24V
Power Consumption (W)	30	30
LED Q'TY (PCS)	48	48
SMD	3030	3030
LED color	● ● ●	
Current	1.25-2.5A	
Modes	4 modes flash (Z-W26 Red+Blue light)	
	4 modes flash + 4 modes rotation + 1 modes cruise (Z-W26 Amber light)	
Compliance	SAE J845 CLASS1 ECE R65 TA1 R10	

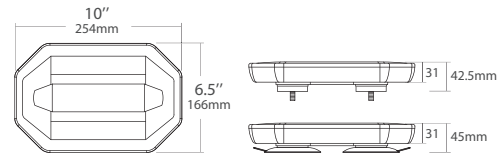

Z-W27 Series Super Slim Minibar



Red+Blue
Light



Z-W27S - Screw mount



Z-W27M - Magnetic mount



Z-W27BR - Bracket installation

Amber
Light



Z-W27S - Screw mount



Z-W27M - Magnetic mount



Z-W27BR - Bracket installation

Item No.	Z-W27S	Z-W27M	Z-W27BR
Input Voltage	12-24V	12-24V	12-24V
Power Consumption (W)	65	65	65
LED Q'TY (PCS)	68	68	68
SMD	3030	3030	3030
LED color	● ● ●		
Current	1.25-2.5A		
Modes	4 modes flash (Z-W27 Red+Blue light)		
	4 modes flash + 4 modes rotation + 1 modes cruise (Z-W27 Amber light)		
Compliance	SAE J845 ECE R65 TA2 R10		

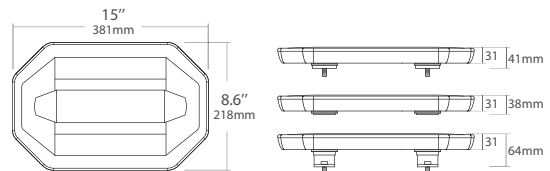

Z-W18 Series
LED Warning Light Bar



ECE R65 Class 2



0.96" INNOVATION EXTREMELY SLIM WARNING BAR

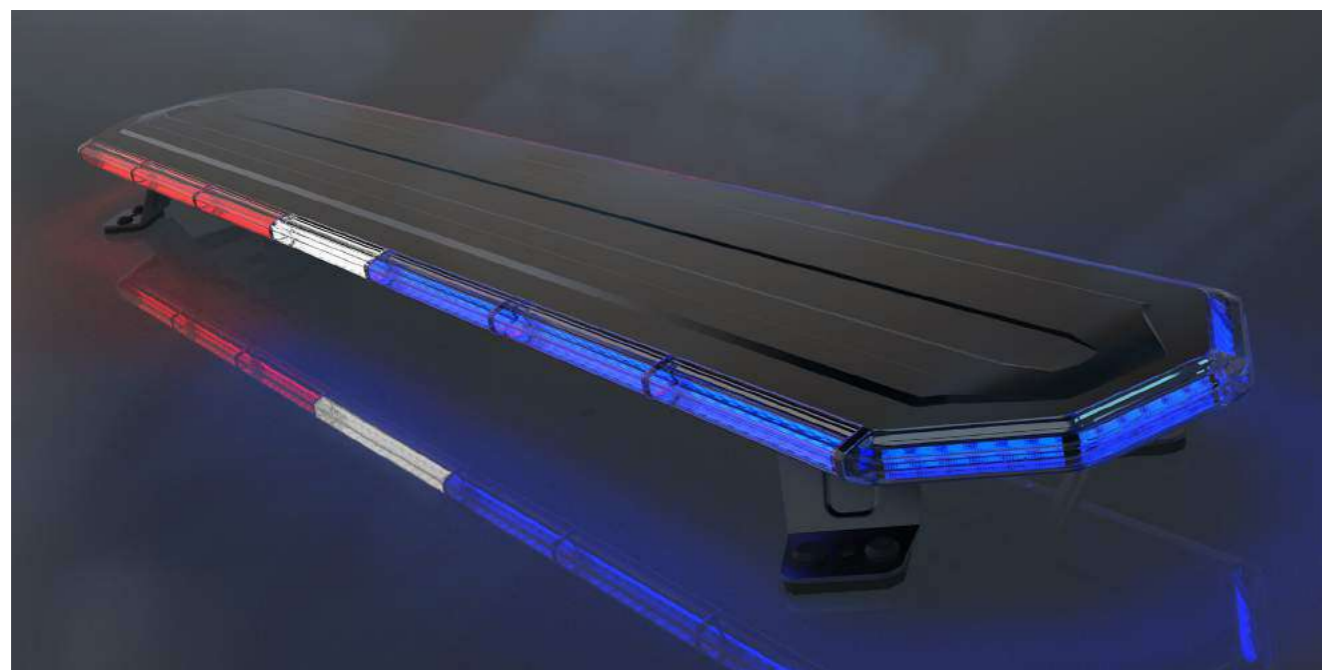

Item No.	Z-W18-24"	Z-W18-30"	Z-W18-42"	Z-W18-48"	Z-W18-60"	Z-W18-72"
Input Voltage	12-24V	12-24V	12-24V	12-24V	12-24V	12-24V
Power Consumption (W)	74	82	98	106	122	138
Current / Voltage	3.08A @ 24V	3.42A @ 24V	4.08A @ 24V	4.42A @ 24V	5.08A @ 24V	5.75A @ 24V
LED Q'TY (PCS)	36+72	36+96	36+144	36+168	36+216	36+264
SMD	3030+2835					
LED color	● ● ● ● ● ●					
Modes	4 modes flash + 5 modes rotation + 1 cruise + 3 modes arrow					
Compliance	CISPR25 CLASS 3 SAE J845 ECE R65 TA2 R10					

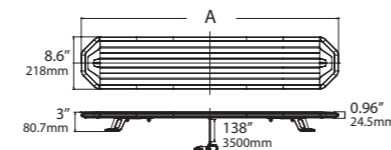

A	Z-W18-24"-- 613mm	Z-W18-48"-- 1223mm
	Z-W18-30"-- 766mm	Z-W18-60"-- 1528mm
	Z-W18-42"-- 1070mm	Z-W18-72"-- 1832mm

Section A Lamp+Remote +

Section B Lamp+Remote +

Section C Lamp + **Hook (Optional)**



Z-W11 Series LED Warning Light Bars

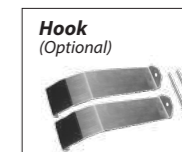

Item No.	Z-W11R-1000	Z-W11M-1000	Z-W11S-1240
Input Voltage	12-24V	12-24V	12-24V
Power Consumption (W)	30	60	60
Current / Voltage	1.25A @ 24V	2.5A @ 24V	2.5A @ 24V
LED Q'TY (PCS)	48	48	48
SMD	3030		
LED color	●		
Modes	8 modes flash		
Compliance	SAE J845 CISPR 25 ECE R65 R10		

Item No.	Z-W11R-1000
Charging interface	DC 5.5/2.1
Electric core	Double section 18650 lithium ion
Capacity	7.4V 7800mAh
Charging voltage	12V/24V
Charging current	1800mA(12V)/900mA(24V)
Charging time	About 5H
Discharging time	About 6H

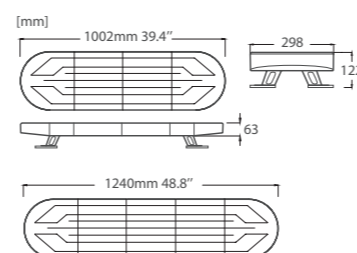

Z-W45 Series
LED Warning Light Bars



GROGOURS DESIGN SUPER SLIM WARNING LIGHT BAR

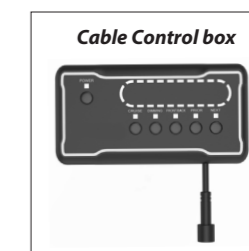

Item No.	Z-W45-23"	Z-W45-41"	Z-W45-47"	Z-W45-59"
Input Voltage	12-24V	12-24V	12-24V	12-24V
Power Consumption (W)	55	79	87	103
Current / Voltage	2.29A @ 24V	3.42A @ 24V	4.08A @ 24V	4.42A @ 24V
LED Q'TY (PCS)	150	222	246	294
SMD	3030+2835			
LED color	●			
Modes	6 modes flash + 5 modes rotation + 2 cruise + 3 modes dynamic			
Compliance	CISPR25 CLASS 3 SAE J845 ECE R65 TA2 R10			

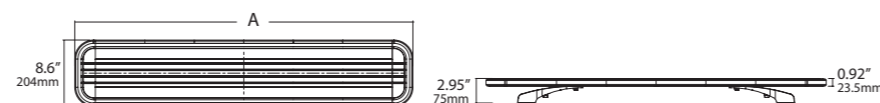

A Z-W45-23"-- 584.2mm Z-W45-41"-- 1041.4mm Z-W45-47"-- 1193.8mm Z-W45-59"-- 1498.6mm



Z-W25 Series
LED Warning Light Bars



LED EMERGENCY STROBE LIGHT BARS



Item No.	Z-W25-19"	Z-W25-31"	Z-W25-37"	Z-W25-49"
Input Voltage	12-24V	12-24V	12-24V	12-24V
Power Consumption (W)	15	25	30	40
Current / Voltage	0.62A @ 24V	1.04A @ 24V	1.25A @ 24V	1.67A @ 24V
LED Q'TY (PCS)	36	60	72	96
SMD	—			
LED color	●			
Modes	3 modes flash + 1 modes dynamic + 1 cruise			
Compliance	SAE J845 ECE R65 TA2 R10			

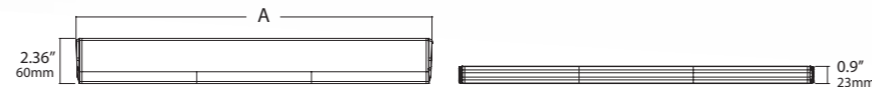

A Z-W25-19"-- 473mm Z-W25-31"-- 778mm Z-W25-37"-- 930mm Z-W25-49"-- 1235mm

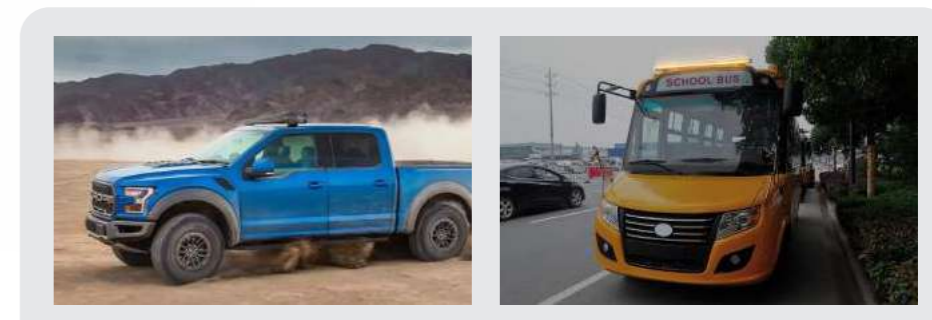

LED MARKER LAMP

- ◆ *Manufactured using latest L.E.D technology.*
- ◆ *LED Neon Effect*
- ◆ *Robust Housing Design*
- ◆ *Fully Sealed to IP 67 Standards*
- ◆ *E Mark Certified Lighting*
- ◆ **ECE R3 R7 R91 Certified**



YTK CO.,LTD.
[Http://www.ytk-group.co.jp](http://www.ytk-group.co.jp)

Z-M19

Auxiliary LED Side Marker With Reflex



Red Cover



Amber Cover

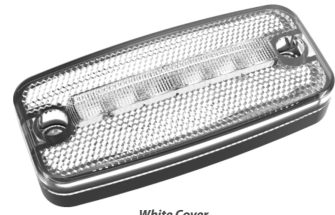

White Cover

Item No.	Z-M19
Input Voltage	12-24V
Power Consumption (W)	0.5W
Current / Voltage	0.02A @ 24V
Lens Material	PC
LED Q'TY (PCS)	6
LED color	● ● ○
Function	Marker
Compliance	ECE R91 R10

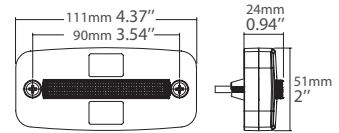

Z-M19 SDMK+D1

Turn Signal And Side Marker Kit With Reflex



Item No.	Z-M19 SDMK+D1
Input Voltage	12-24V
Power Consumption (W)	0.5W / 1W
Current / Voltage	0.02A/0.04A @ 24V
Lens Material	PC
LED Q'TY (PCS)	12
LED color	●
Function	Marker
Compliance	ECE R91 R6 R10

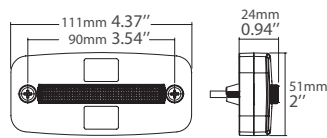

YTK CO.,LTD.
[Http://www.ytk-group.co.jp](http://www.ytk-group.co.jp)

Z-M141 LED Side Marker lamp with Reflex Reflector



Red Cover



Amber Cover



White Cover

Item No.	Z-M141
Input Voltage	12-24V
Power Consumption (W)	0.6W(12V) / 1.2W(24V)
Current / Voltage	0.05A @ 24V
Lens Material	PC
LED Q'TY (PCS)	2
LED color	● ● ○
Function	Marker
Compliance	ECE R3 R7 R91 R10

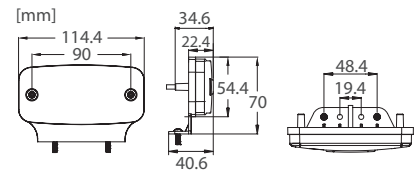

Z-M161 LED Side Marker lamp with Reflex Reflector



Red Cover



Amber Cover



White Cover

Item No.	Z-M161
Input Voltage	12-24V
Power Consumption (W)	0.09W(12V) / 0.3W(24V)
Current / Voltage	0.01A @ 24V
Lens Material	PC
LED Q'TY (PCS)	4
LED color	● ● ○ ○
Function	Marker
Compliance	ECE R3 R7 R91 R10

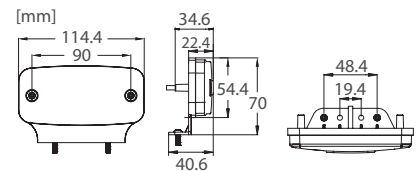

Z-M001 (Left) / Z-M002 (Right) LED End-Outline Marker Light



Item No.	Z-M001 (left) / Z-M002 (right)
Input Voltage	12-24V
Power Consumption (W)	FPL: 2.2 / RPL: 3 / SDM: 2.2
Current / Voltage	0.09-0.12A @ 24V
Lens Material	PC
LED Q'TY (PCS)	FPL: 45 / RPL: 45 / SDM: 6
LED color	Orange
Function	Marker
Compliance	ECE R7 R91 R10

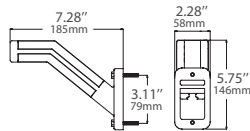

Z-M011 (left/right) LED End-Outline Marker Light



Item No.	Z-M011 (left/right)
Input Voltage	12-24V
Power Consumption (W)	2W
Current / Voltage	0.08A @ 24V
Lens Material	PC
LED Q'TY (PCS)	12
LED color	Red, White
Function	Marker
Compliance	ECE R7 R10

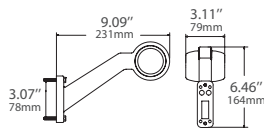

Z-M061 LED Number Plate light



Item No.	Z-M061
Input Voltage	12-24V
Power Consumption (W)	1.5W
Current / Voltage	0.06A @ 24V
Lens Material	PC
LED Q'TY (PCS)	4
LED color	White
Function	Marker
Compliance	ECE R4 R10

