

FT-2317-KV800

- 螺旋槳Propeller: MR10*4.5
- KV值(RPM/V): 800
- 槽級數 Slots/Poles Count: 12S / 14P
- 電阻 Resistance(mΩ): 107 ±5%
- 電機尺寸 Dimension(mm): Ø28.8 x 33.7
- 重量 Weight(g): 81.5
- 軸徑 Diameter(mm): Ø4
- 額定電壓 Voltage rating(V): 2~4S (7.4 ~ 14.8 V)
- 馬達轉向螺旋槳端(非出口線端): CCW

Motor rotation direction, viewed from the propeller end (non-output wire end): CCW

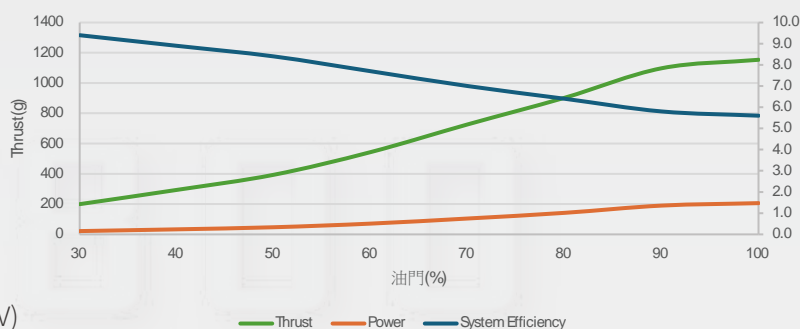

Throttle(%)	Duty(us)	Vdc(V)	Current(A)	Power(W)	Speed(Rpm)	Thrust(g)	System Efficiency(G/W)
30	1300	14.9	1.4	21	3231	200	9.4
40	1400	14.9	2.2	33	3797	294	8.9
50	1500	14.9	3.1	47	4297	394	8.4
60	1600	14.9	4.8	71	4966	544	7.7
70	1700	14.8	7.0	105	5634	727	7.0
80	1800	14.8	9.6	142	6213	903	6.4
90	1900	14.7	12.9	190	6773	1098	5.8
100	2000	14.7	14.0	206	6934	1154	5.6

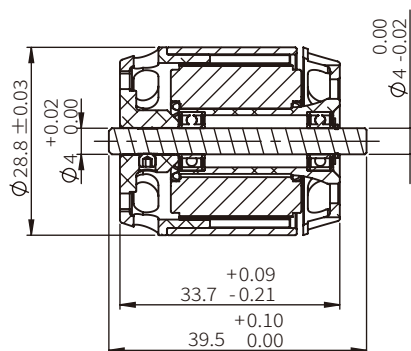
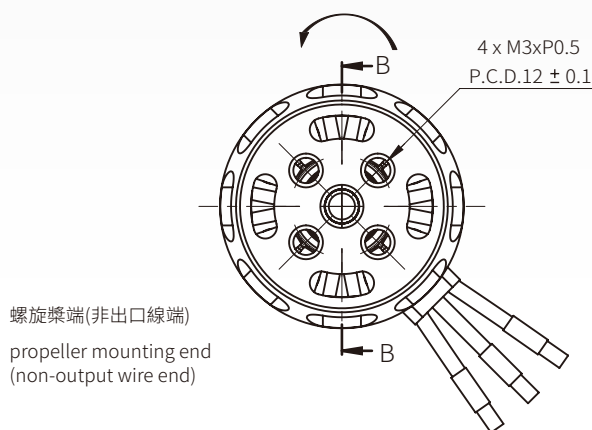
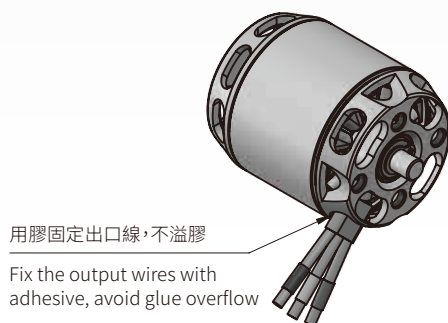

SECTION B-B

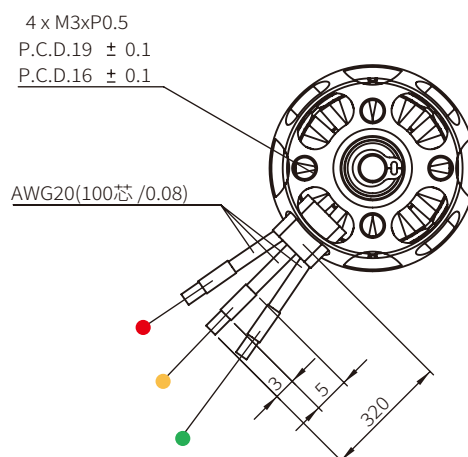

出口線定義 Output wire definition

- 紅色熱縮 Red heat shrink tubing: U
- 黃色熱縮 Yellow heat shrink tubing: V
- 綠色熱縮 Green heat shrink tubing: W

FT-2806-KV760

- 螺旋槳Propeller: 12"x5"
- KV值(RPM/V): 760
- 槽級數 Slots/Poles Count: 12S / 14P
- 電阻 Resistance($m\Omega$): $172 \pm 5\%$
- 電機尺寸 Dimension(mm): $\varnothing 35 \times 19.45$
- 重量 Weight(g): 57
- 軸徑 Diameter(mm): $\varnothing 4$
- 額定電壓 Voltage rating(V): 4~6S (14.8 ~ 22.2 V)
- 馬達轉向螺旋槳端(非出口線端): CCW

Motor rotation direction, viewed from the propeller end (non-output wire end): CCW

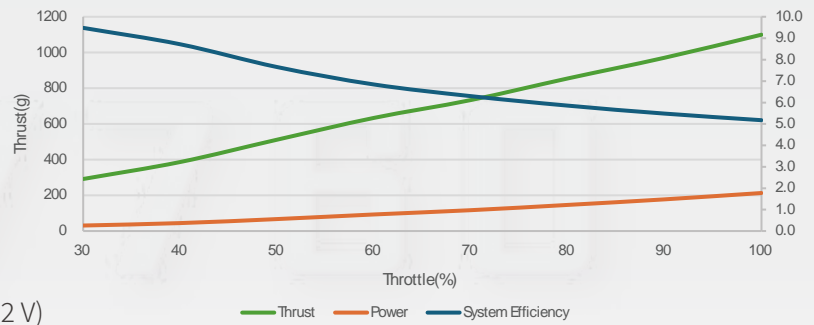

Throttle(%)	Duty(us)	Vdc(V)	Current(A)	Power(W)	Speed(Rpm)	Thrust(g)	System Efficiency(G/W)
30	1300	14.8	2.1	31	3572	292	9.5
40	1400	14.8	3.0	44	4063	387	8.7
50	1500	14.8	4.6	67	4690	512	7.7
60	1600	14.8	6.3	93	5208	634	6.8
70	1700	14.7	8.0	117	5608	734	6.3
80	1800	14.7	9.9	146	5936	855	5.9
90	1900	14.7	12.6	177	6354	971	5.5
100	2000	14.7	15.6	213	6538	1100	5.2

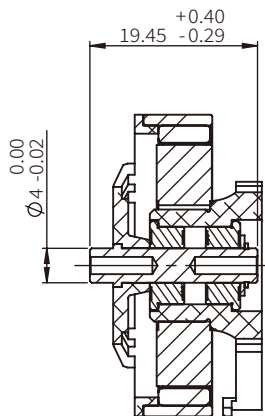
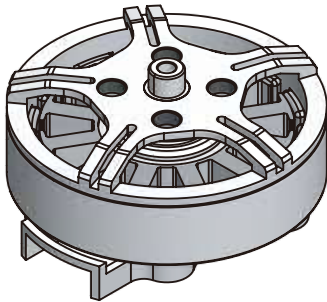

SECTION B-B

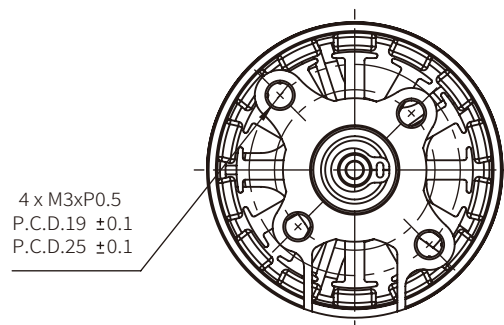
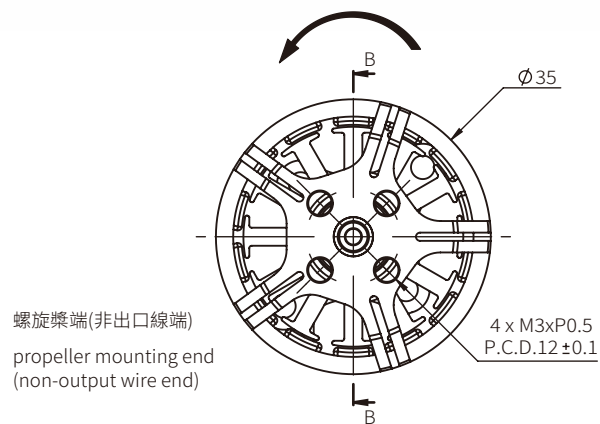

出口線定義 Output wire definition

- 紅色熱縮Red heat shrink tubing: U
- 黃色熱縮Yellow heat shrink tubing: V
- 綠色熱縮Green heat shrink tubing: W

FT-2808-KV630

- 螺旋槳Propeller: 12"x5"
- KV值(RPM/V): 630
- 槽級數 Slots/Poles Count: 12S / 14P
- 電阻 Resistance($m\Omega$): $130.75 \pm 5\%$
- 電機尺寸 Dimension(mm): $\varnothing 35 \times 35.25$
- 重量 Weight(g): 66
- 軸徑 Diameter(mm): $\varnothing 4.9$
- 額定電壓 Voltage rating(V): 4~6S (14.8 ~ 22.2 V)
- 馬達轉向螺旋槳端(非出口線端): CCW

Motor rotation direction, viewed from the propeller end (non-output wire end): CCW

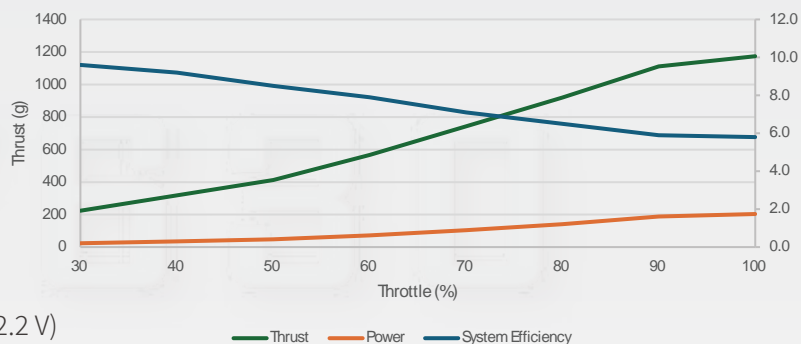

Throttle(%)	Duty(us)	Vdc(V)	Current(A)	Power(W)	Speed(Rpm)	Thrust(g)	System Efficiency(G/W)
30	1300	14.9	1.6	23.4	3247	224	9.6
40	1400	14.9	2.3	34.8	3806	319	9.2
50	1500	14.8	3.3	48.4	4310	413	8.5
60	1600	14.8	4.8	71.8	4980	567	7.9
70	1700	14.8	7.0	104.4	5659	743	7.1
80	1800	14.8	9.6	141.7	6249	921	6.5
90	1900	14.7	12.8	187.8	6809	1112	5.9
100	2000	14.7	13.9	203.9	6973	1174	5.8

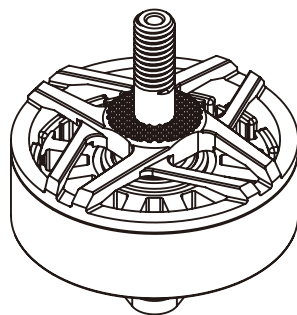

螺旋槳端(非出口線端)
propeller mounting end
(non-output wire end)

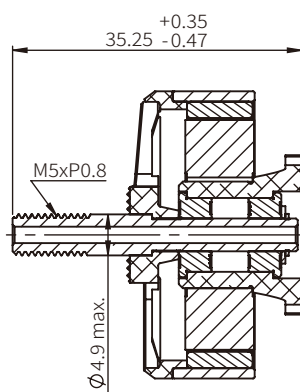
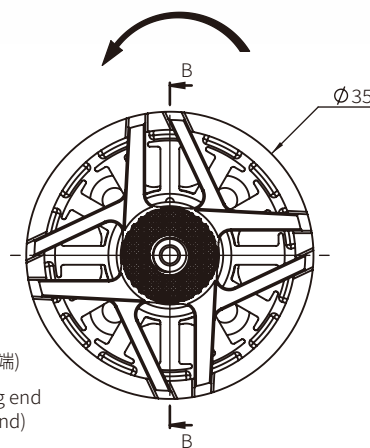

SECTION B-B

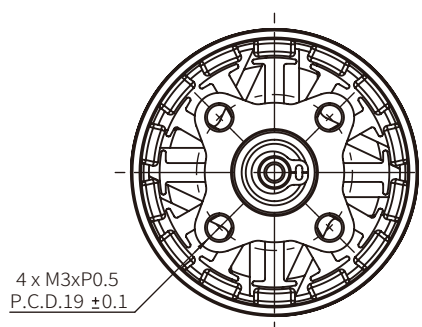

出口線定義 Output wire definition

- 紅色熱縮Red heat shrink tubing: U
- 黃色熱縮Yellow heat shrink tubing: V
- 綠色熱縮Green heat shrink tubing: W

FT-2810-KV710

- 螺旋槳Propeller: 12"x5"
- KV值(RPM/V): 710
- 槽級數 Slots/Poles Count: 12S / 14P
- 電阻 Resistance($m\Omega$): $89 \pm 5\%$
- 電機尺寸 Dimension(mm): $\varnothing 35 \times 37.25$
- 重量 Weight(g): 77
- 軸徑 Diameter(mm): $\varnothing 4.9$
- 額定電壓 Voltage rating(V): 4~6S (14.8~22.2 V)
- 馬達轉向螺旋槳端(非出口線端): CCW

Motor rotation direction, viewed from the propeller end (non-output wire end): CCW

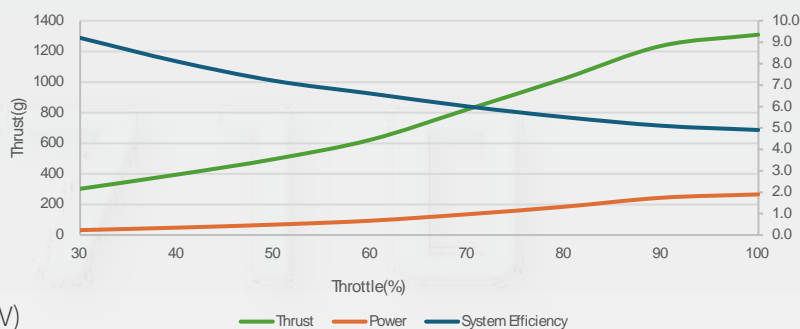

Throttle(%)	Duty(us)	Vdc(V)	Current(A)	Power(W)	Speed(Rpm)	Thrust(g)	System Efficiency(G/W)
30	1300	14.9	2.2	33	3710	302	9.2
40	1400	14.8	3.3	49	4295	395	8.1
50	1500	14.7	4.7	69	4844	496	7.2
60	1600	14.8	6.4	94	5416	623	6.6
70	1700	14.8	9.2	137	6129	822	6.0
80	1800	14.8	12.6	186	6758	1024	5.5
90	1900	14.7	16.6	244	7332	1237	5.1
100	2000	14.7	18.1	266	7507	1310	4.9

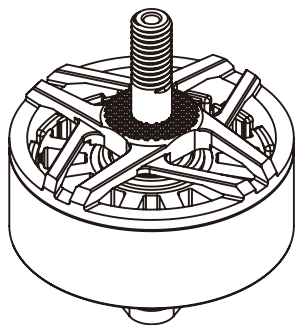

螺旋槳端(非出口線端)
propeller mounting end
(non-output wire end)

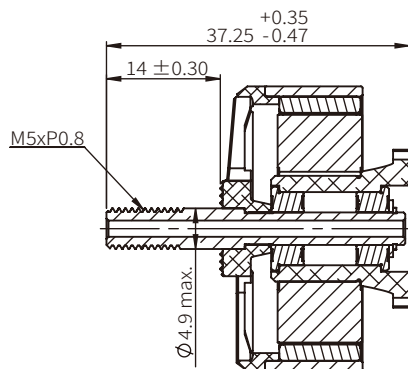
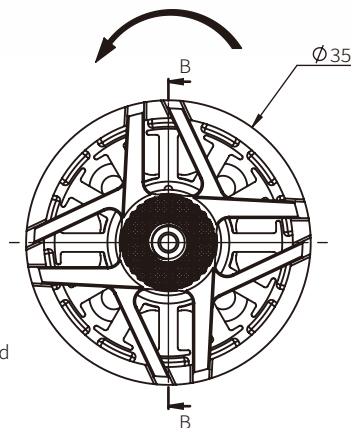

SECTION B-B

4 x M3xP0.5
P.C.D.19 ± 0.1

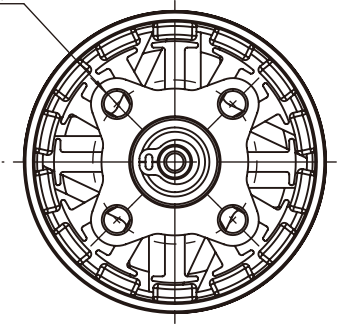

出口線定義 Output wire definition

- 紅色熱縮 Red heat shrink tubing: U
- 黃色熱縮 Yellow heat shrink tubing: V
- 綠色熱縮 Green heat shrink tubing: W

FT-3115-KV900

- 螺旋槳Propeller: 9x5x3
- KV值(RPM/V): 900
- 槽級數 Slots/Poles Count: 12S / 14P
- 電阻 Resistance(mΩ): $38.5 \pm 5\%$
- 電機尺寸 Dimension(mm): $\varnothing 37.5 \times 48$
- 重量 Weight(g): 120
- 軸徑 Diameter(mm): $\varnothing 4.9$
- 額定電壓 Voltage rating(V): 4~6S (14.8~22.2 V)
- 馬達轉向螺旋槳端(非出口線端): CCW

Motor rotation direction, viewed from the propeller end (non-output wire end): CCW

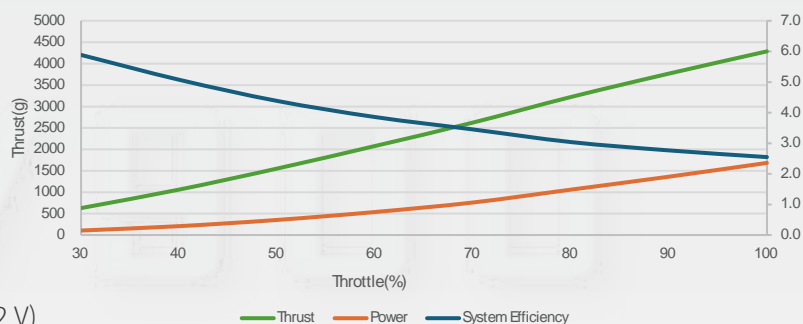

Throttle(%)	Duty(us)	Vdc(V)	Current(A)	Power(W)	Speed(Rpm)	Thrust(g)	System Efficiency(G/W)
30	1300	25.2	4.3	107	6331	630	5.9
40	1400	25.2	8.3	209	8082	1061	5.1
50	1500	25.2	14.0	354	9606	1552	4.4
60	1600	25.5	21.3	539	11062	2079	3.9
70	1700	25.1	30.3	761	12344	2626	3.5
80	1800	25.1	42.2	1061	13532	3223	3.0
90	1900	25.1	54.3	1363	14551	3769	2.8
100	2000	25.0	67.4	1684	15365	4288	2.5

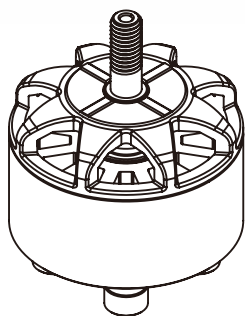

螺旋槳端(非出口線端)
propeller mounting end
(non-output wire end)

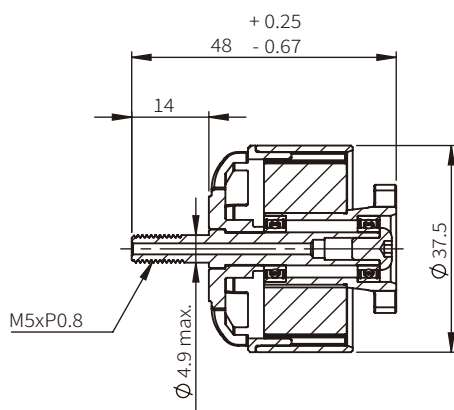
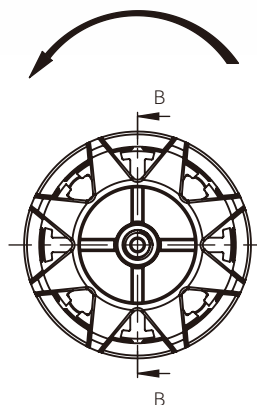

SECTION B-B

4 x M3xP0.5
P.C.D.19 ± 0.1

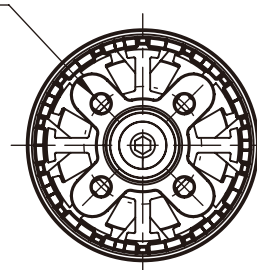

出口線定義 Output wire definition

- 紅色熱縮 Red heat shrink tubing: U
- 黃色熱縮 Yellow heat shrink tubing: V
- 綠色熱縮 Green heat shrink tubing: W

FT-3510-KV630

- 螺旋槳Propeller: 13*4.4R
- KV值(RPM/V): 630
- 槽級數 Slots/Poles Count: 12S / 14P
- 電阻 Resistance($m\Omega$): $93 \pm 5\%$
- 電機尺寸 Dimension(mm): $\varnothing 41.8 \times 36.6$
- 重量 Weight(g): 113
- 軸徑 Diameter(mm): $\varnothing 4$
- 額定電壓 Voltage rating(V): 3~4S (11.1~14.8 V)
- 馬達轉向螺旋槳端(非出口線端): CCW

Motor rotation direction, viewed from the propeller end (non-output wire end): CCW

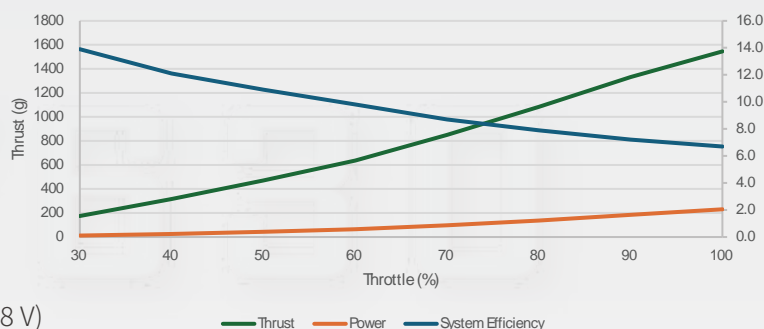

Throttle(%)	Duty(us)	Vdc(V)	Current(A)	Power(W)	Speed(Rpm)	Thrust(g)	System Efficiency(G/W)
30	1300	15.1	0.8	13	2562	175	13.9
40	1400	15.0	1.7	26	3408	316	12.1
50	1500	15.0	2.9	43	4120	470	10.9
60	1600	14.8	4.4	65	4778	636	9.8
70	1700	14.9	6.5	97	5524	851	8.7
80	1800	14.9	9.2	138	6219	1083	7.9
90	1900	15.0	12.3	185	6876	1331	7.2
100	2000	15.0	15.4	230	7380	1546	6.7

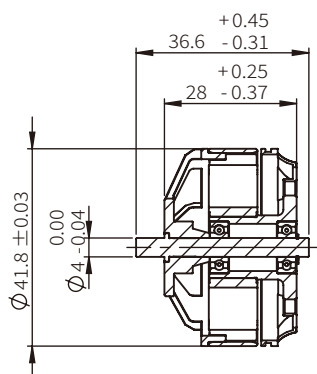
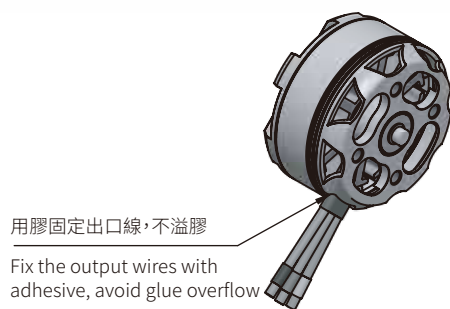

SECTION B-B

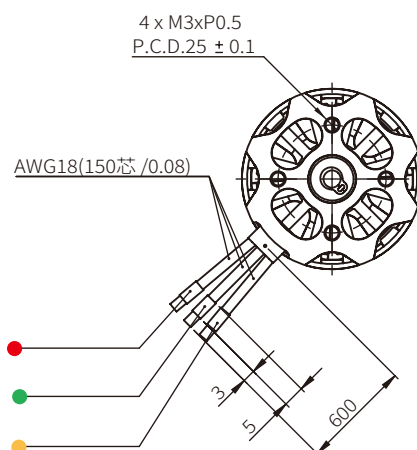
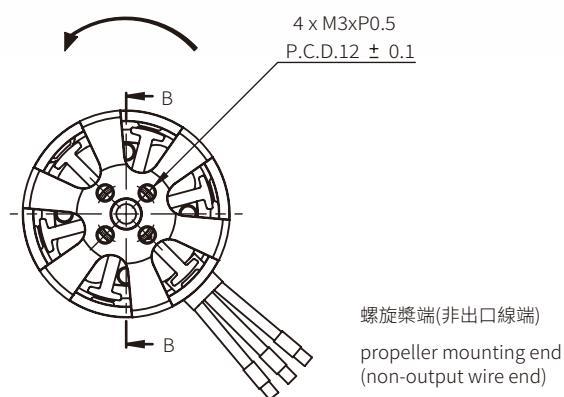

出口線定義 Output wire definition

- 紅色熱縮Red heat shrink tubing: U
- 黃色熱縮Yellow heat shrink tubing: V
- 綠色熱縮Green heat shrink tubing: W

FT-4035-KV250

- 螺旋槳Propeller: 16"x10"x3"
- KV值(RPM/V): 250
- 槽級數 Slots/Poles Count: 12S / 14P
- 電阻 Resistance(mΩ): $37.5 \pm 5\%$
- 電機尺寸 Dimension(mm): $\varnothing 50 \times 95$
- 重量 Weight(g): $470 \pm 5g$
- 軸徑 Diameter(mm): $\varnothing 8$
- 額定電壓 Voltage rating(V): 12~14S (44~50V)
- 馬達轉向螺旋槳端(非出口線端): CW

Motor rotation direction, viewed from the propeller end (non-output wire end): CW

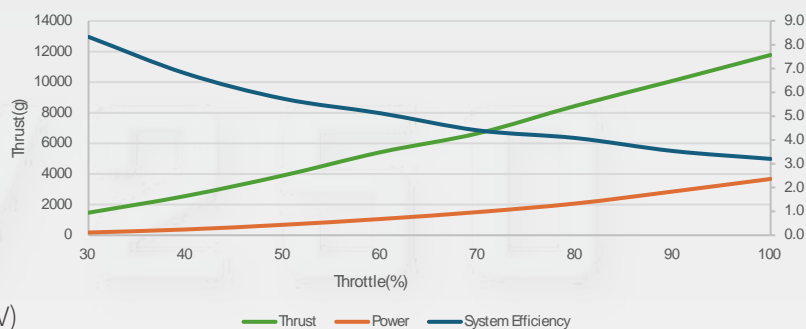

Throttle(%)	Duty(us)	Vdc(V)	Current(A)	Power(W)	Speed(Rpm)	Thrust(g)	System Efficiency(G/W)
30	1300	48.1	3.7	176	3334	1469	8.3
40	1400	48.1	7.9	378	4428	2564	6.8
50	1500	48.1	14.2	681	5447	3906	5.7
60	1600	48.1	22.0	1060	6323	5427	5.1
70	1700	48.0	31.5	1512	7120	6660	4.4
80	1800	48.0	43.1	2070	7863	8454	4.1
90	1900	47.9	59.5	2852	8668	10095	3.5
100	2000	47.3	77.5	3670	9328	11778	3.2

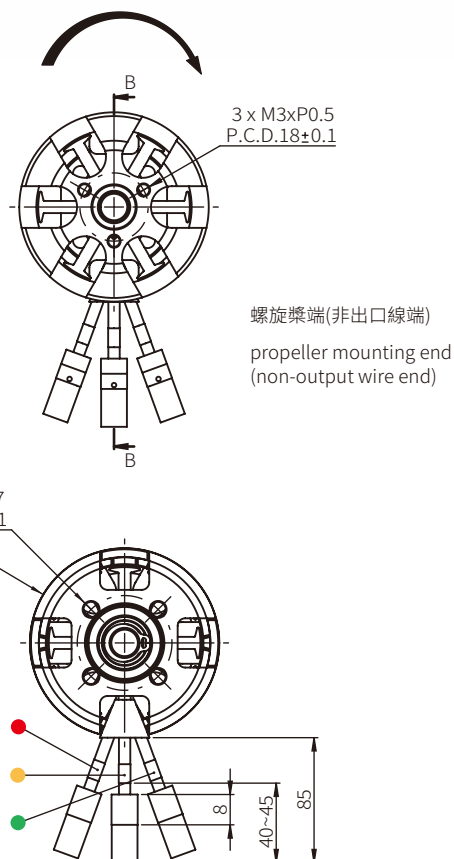
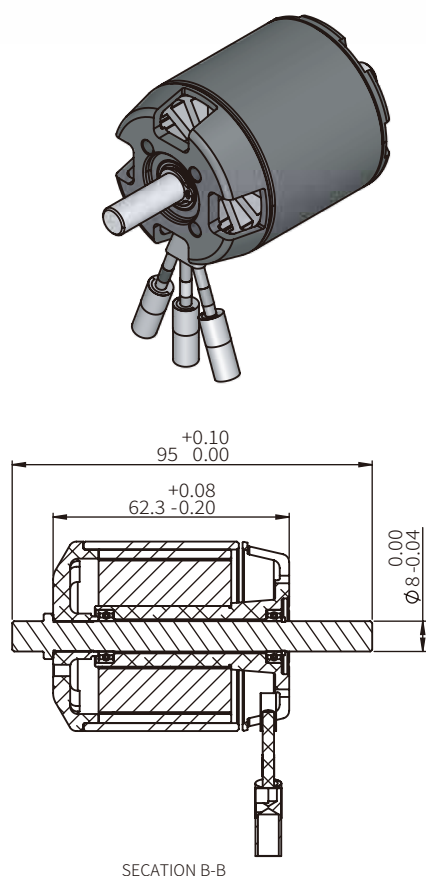

出口線定義 Output wire definition

- 紅色熱縮Red heat shrink tubing: U
- 黃色熱縮Yellow heat shrink tubing: V
- 綠色熱縮Green heat shrink tubing: W

FT-6007-KV160

- 螺旋槳Propeller: P22*6.6
- KV值(RPM/V): 160
- 槽級數 Slots/Poles Count: 24S / 28P
- 電阻 Resistance($m\Omega$): $171 \pm 5\%$
- 電機尺寸 Dimension(mm): $\varnothing 67.6 \times 27.9$
- 重量 Weight(g): 182
- 軸徑 Diameter(mm): $\varnothing 6$
- 額定電壓 Voltage rating(V): 6~12S(22.2~48V)
- 馬達轉向螺旋槳端(非出口線端): CCW

Motor rotation direction, viewed from the propeller end (non-output wire end): CCW

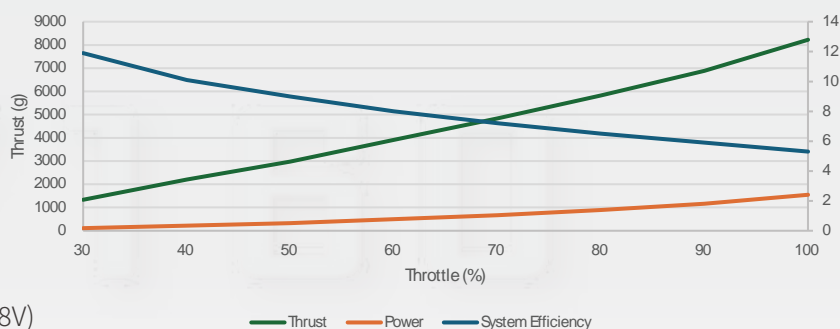

Throttle(%)	Duty(us)	Vdc(V)	Current(A)	Power(W)	Speed(Rpm)	Thrust(g)	System Efficiency(G/W)
30	1300	48.1	2.3	111	2513	1331	11.9
40	1400	48.1	4.5	218	3178	2200	10.1
50	1500	48.1	6.9	330	3658	2973	9
60	1600	48.1	10.2	492	4172	3913	8
70	1700	48.1	13.9	672	4607	4837	7.2
80	1800	48.1	18.5	892	5046	5826	6.5
90	1900	48.1	24.1	1161	5469	6888	5.9
100	2000	48.1	32.2	1547	5937	8230	5.3



用膠固定出口線，不溢膠
Fix the output wires with adhesive, avoid glue overflow

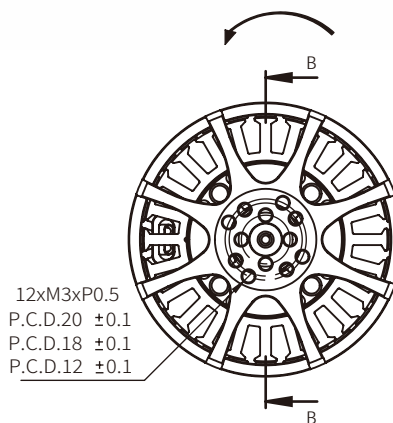

螺旋槳端(非出口線端)
propeller mounting end
(non-output wire end)

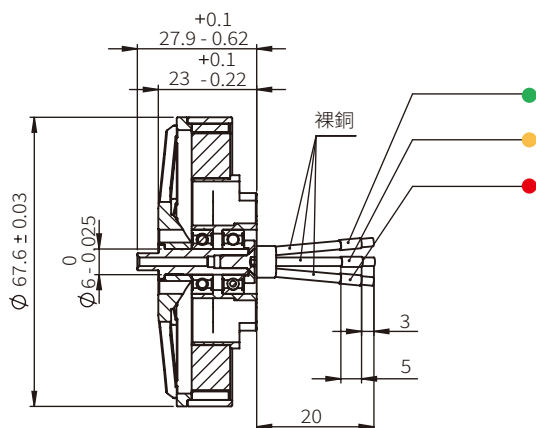

4xM4xP0.7
P.C.D.32 ± 0.1

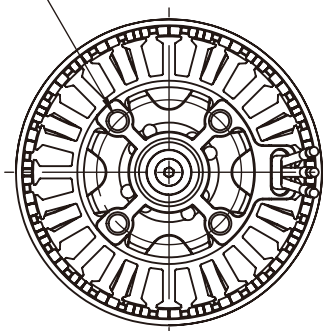

出口線定義 Output wire definition

- 紅色熱縮 Red heat shrink tubing: U
- 黃色熱縮 Yellow heat shrink tubing: V
- 綠色熱縮 Green heat shrink tubing: W

FT-60-KV170

- 螺旋槳Propeller: P22*6.6
- KV值(RPM/V): 170
- 槽級數 Slots/Poles Count: 24N/ 28P
- 電阻 Resistance(mΩ): $79.2 \pm 5\%$
- 電機尺寸 Dimension(mm): $\varnothing 69 \times 40.8$
- 重量 Weight(g): 340
- 軸徑 Diameter(mm): $\varnothing 6$
- 額定電壓 Voltage rating(V): 6~14S (22.2~51.8V)
- 馬達轉向螺旋槳端(非出口線端): CCW

Motor rotation direction, viewed from the propeller end (non-output wire end): CCW

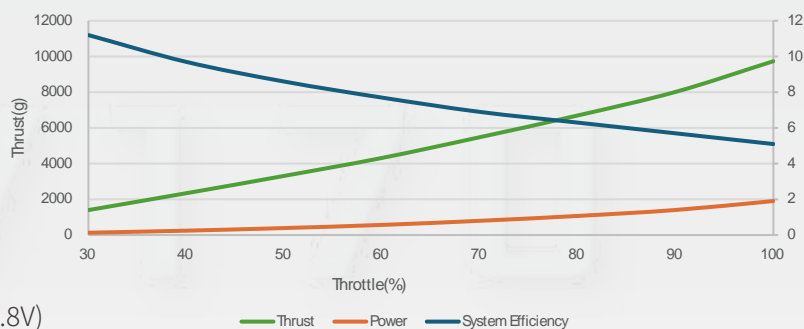

Throttle(%)	Duty(us)	Vdc(V)	Current(A)	Power(W)	Speed(Rpm)	Thrust(g)	System Efficiency(G/W)
30	1300	48.0	2.6	126	2584	1405	11.2
40	1400	48.0	5.1	243	3250	2349	9.7
50	1500	48.0	8.1	388	3817	3318	8.6
60	1600	48.0	11.7	564	4321	4324	7.7
70	1700	48.0	16.6	795	4834	5486	6.9
80	1800	48.0	22.3	1068	5309	6703	6.3
90	1900	47.9	29.2	1401	5776	8022	5.7
100	2000	47.9	39.7	1903	6327	9741	5.1

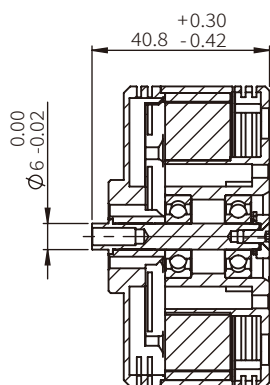
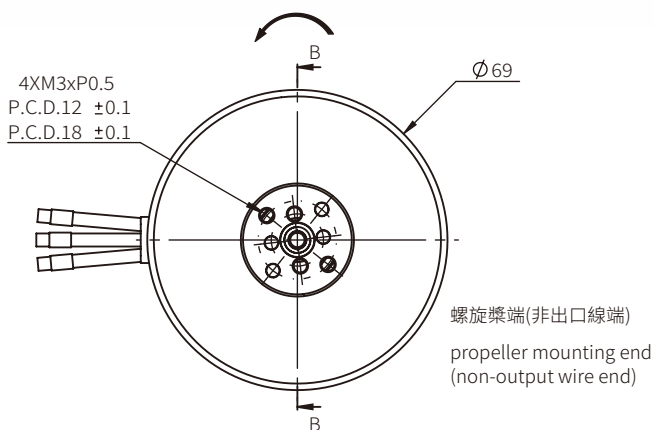
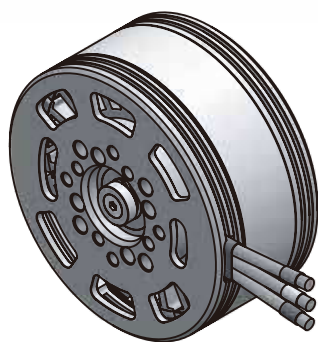

SECTION B-B

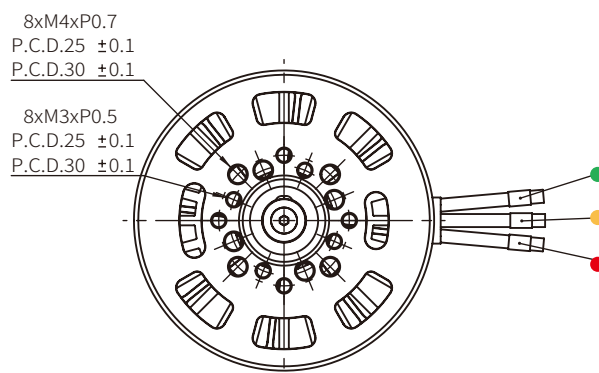

出口線定義 Output wire definition

- 紅色熱縮Red heat shrink tubing: U
- 黃色熱縮Yellow heat shrink tubing: V
- 綠色熱縮Green heat shrink tubing: W

FT-605-KV210

- 螺旋槳Propeller: V22*7.4
- KV值(RPM/V): 210
- 槽級數 Slots/Poles Count: 24N / 28P
- 線電阻 Resistance(mΩ): $44.2 \pm 5\%$
- 電機尺寸 Dimension(mm): $\Phi 69 \times 39.9$
- 重量 Weight(g): 358.6
- 軸徑 Diameter(mm): $\Phi 6$
- 額定電壓 Voltage rating(V): 12S (42~52 V)
- 馬達轉向螺旋槳端(非出口線端): CCW

Motor rotation direction, viewed from the propeller end (non-output wire end): CCW

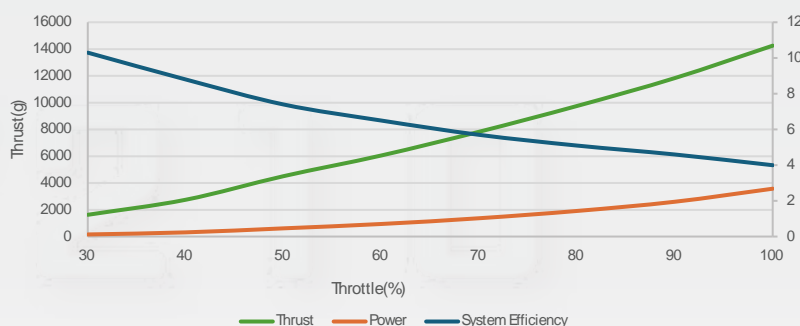

Throttle(%)	Duty(us)	Vdc(V)	Current(A)	Power(W)	Speed(Rpm)	Thrust(g)	System Efficiency(G/W)
30	1300	48.0	3.3	159	2557	1635	10.3
40	1400	47.9	6.5	313	3300	2758	8.8
50	1500	47.8	12.8	614	4191	4519	7.4
60	1600	47.8	19.7	939	4824	6065	6.5
70	1700	47.7	28.7	1368	5452	7838	5.7
80	1800	47.5	40.2	1912	6057	9762	5.1
90	1900	47.3	54.9	2599	6645	11846	4.6
100	2000	47.1	75.9	3571	7236	14265	4

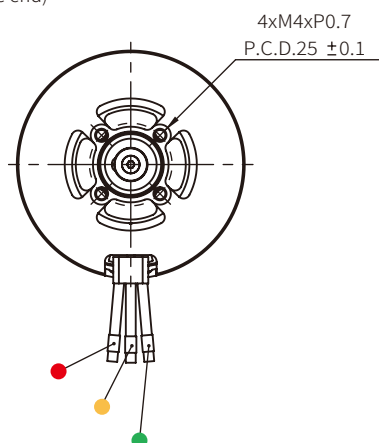
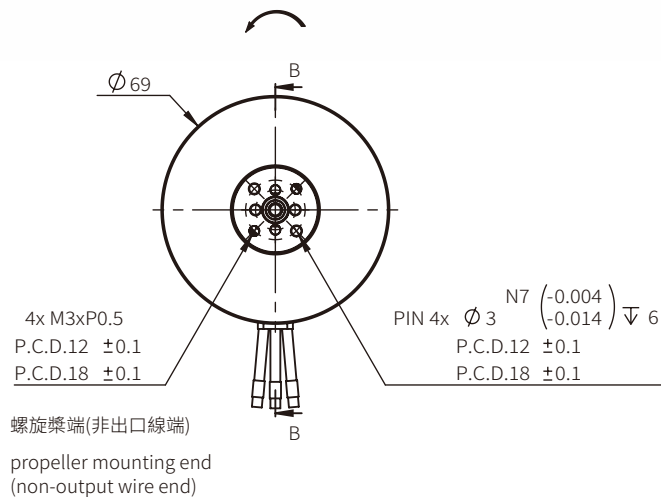
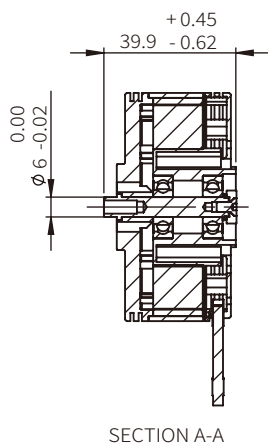
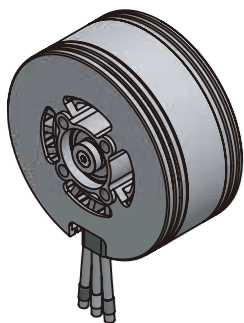

出口線定義 Output wire definition

- 紅色熱縮Red heat shrink tubing: U
- 黃色熱縮Yellow heat shrink tubing: V
- 綠色熱縮Green heat shrink tubing: W

FT-105-KV105

- 螺旋槳Propeller: 27.5*8.9
- KV值(RPM/V): 105
- 槽級數 Slots/Poles Count: 24N / 28P
- 電阻 Resistance(mΩ): 168 ±5%
- 電機尺寸 Dimension(mm): Ø109.1x68.7
- 重量 Weight(g): 1180±2%
- 軸徑 Diameter(mm): Ø10
- 額定電壓 Voltage rating(V): 12S (52V)
- 馬達轉向螺旋槳端(非出口線端): CCW

Motor rotation direction, viewed from the propeller end (non-output wire end): CCW

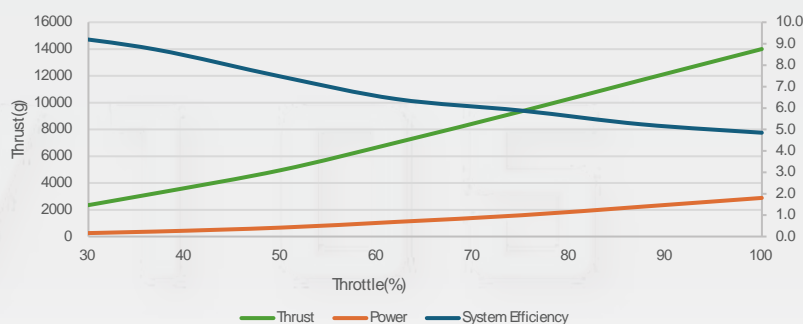

Throttle(%)	Duty(us)	Vdc(V)	Current(A)	Power(W)	Speed(Rpm)	Thrust(g)	System Efficiency(G/W)
25	1250	50.4	3.6	182	1870	1728	9.5
37	1370	50.3	7.4	370	2490	3231	8.7
50	1500	50.3	13.2	664	3110	4960	7.5
62	1620	50.4	21.7	1093	3710	7016	6.4
75	1750	50.3	31.6	1591	4240	9354	5.9
88	1880	50.2	44.3	2233	4730	11697	5.2
100	2000	50.2	57.4	2891	5150	14010	4.8

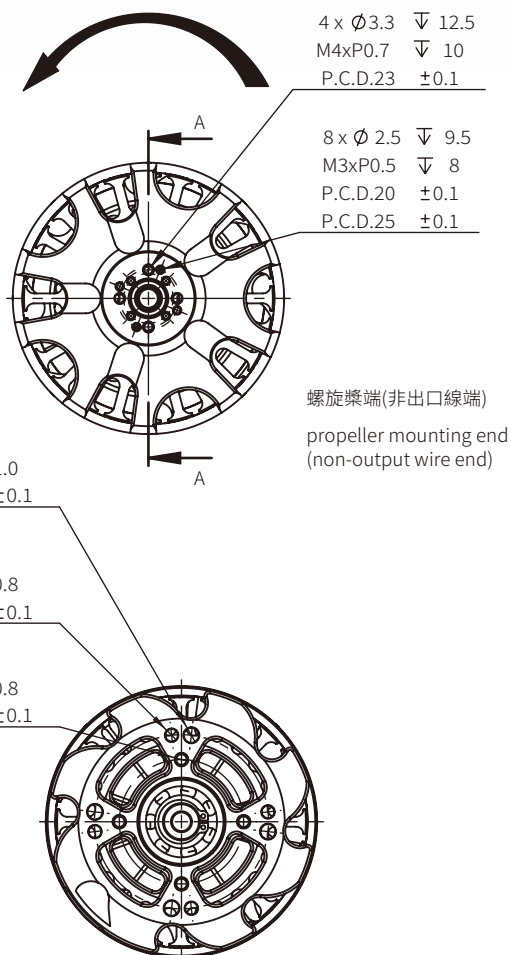
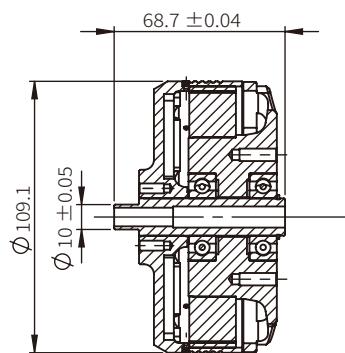
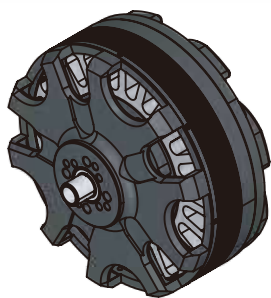

出口線定義 Output wire definition

- 紅色熱縮Red heat shrink tubing: U
- 黃色熱縮Yellow heat shrink tubing: V
- 綠色熱縮Green heat shrink tubing: W

FT-10-KV160

- 螺旋槳Propeller: G30*10.5
- KV值(RPM/V): 160
- 槽級數 Slots/Poles Count: 36S / 42P
- 電阻 Resistance(mΩ): $10.5 \pm 5\%$
- 電機尺寸 Dimension(mm): $\varnothing 106.6 \times 48$
- 重量 Weight(g): 864
- 軸徑 Diameter(mm): $\varnothing 11$
- 額定電壓 Voltage rating(V): 10~12S (42~52V)
- 馬達轉向螺旋槳端(非出口線端): CCW

Motor rotation direction, viewed from the propeller end (non-output wire end): CCW

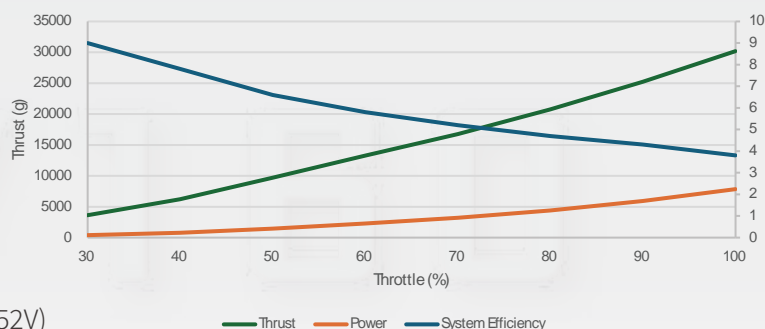

Throttle(%)	Duty(us)	Vdc(V)	Current(A)	Power(W)	Speed(Rpm)	Thrust(g)	System Efficiency(G/W)
30	1300	48.2	8.4	403	2048	3630	9
40	1400	48.1	16.6	797	2666	6200	7.8
50	1500	47.9	30.4	1460	3312	9693	6.6
60	1600	47.7	47.7	2274	3845	13264	5.8
70	1700	47.5	67.4	3200	4290	16763	5.2
80	1800	47.2	93.3	4402	4738	20758	4.7
90	1900	46.7	126.8	5926	5190	25222	4.3
100	2000	46.2	170.2	7859	5629	30191	3.8

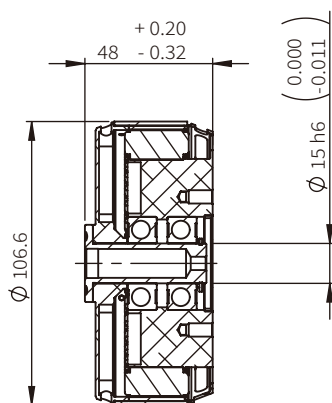
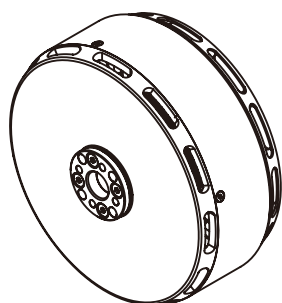

SECTION B-B

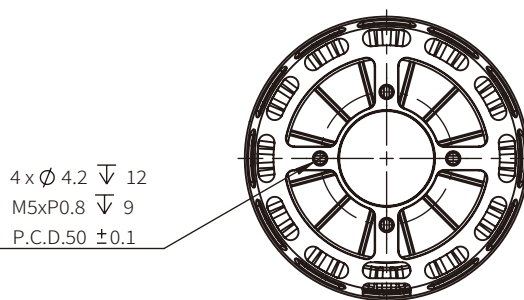
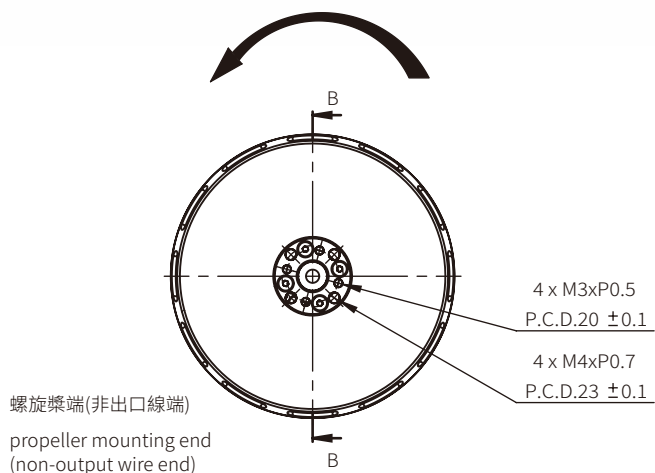

出口線定義 Output wire definition

- 紅色熱縮Red heat shrink tubing: U
- 黃色熱縮Yellow heat shrink tubing: V
- 綠色熱縮Green heat shrink tubing: W

FT-10L-KV170

- 螺旋槳Propeller: G30*10.5
- KV值(RPM/V): 170
- 槽級數 Slots/Poles Count: 36S /42P
- 電阻 Resistance(mΩ): $8.2 \pm 5\%$
- 電機尺寸 Dimension(mm): $\varnothing 106.6 \times 53$
- 重量 Weight(g): 986
- 軸徑 Diameter(mm): $\varnothing 15$
- 額定電壓 Voltage rating(V): 12~14S (42~52V)
- 馬達轉向螺旋槳端(非出口線端): CCW

Motor rotation direction, viewed from the propeller end (non-output wire end): CCW

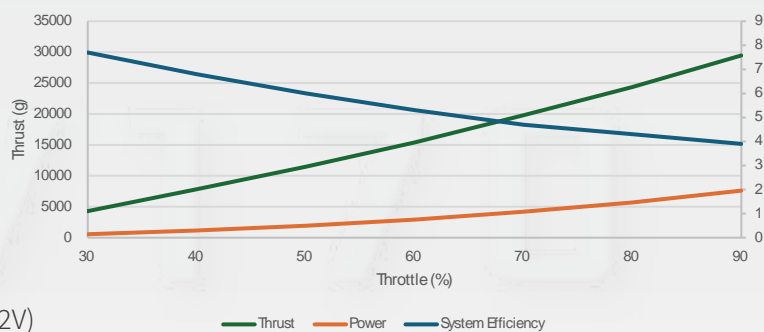

Throttle(%)	Duty(us)	Vdc(V)	Current(A)	Power(W)	Speed(Rpm)	Thrust(g)	System Efficiency(G/W)
30	1300	47.9	11.6	555	2234	4290	7.7
40	1400	47.7	24.2	1153	2979	7840	6.8
50	1500	47.5	40.5	1926	3575	11471	6
60	1600	47.2	61.5	2906	4114	15390	5.3
70	1700	46.9	89.4	4193	4641	19799	4.7
80	1800	46.5	122.6	5700	5108	24370	4.3
90	1900	45.9	165.8	7615	5567	29466	3.9

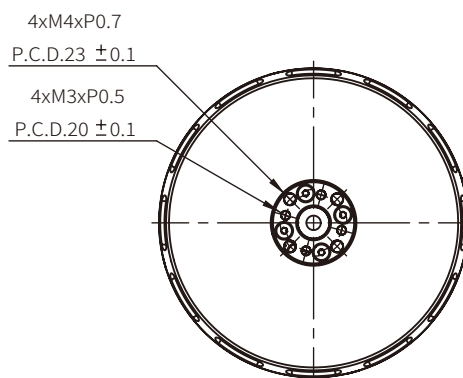
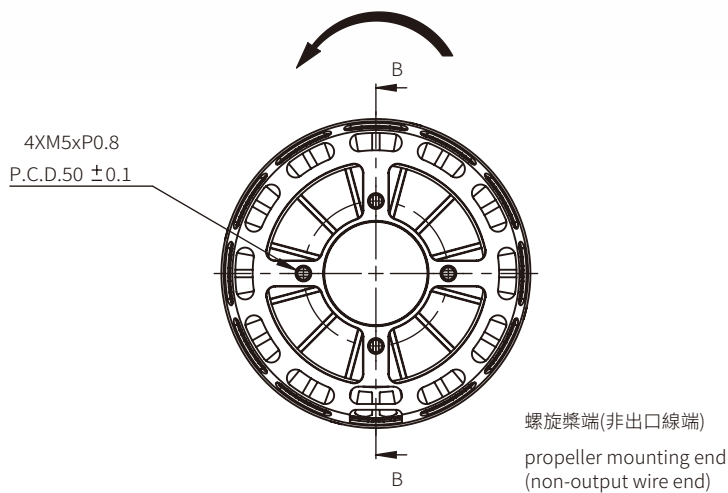
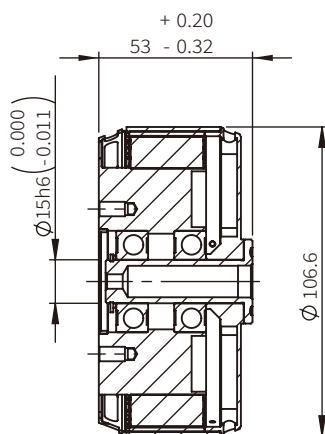
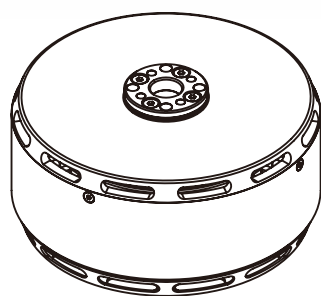

出口線定義 Output wire definition

- 紅色熱縮Red heat shrink tubing: U
- 黃色熱縮Yellow heat shrink tubing: V
- 綠色熱縮Green heat shrink tubing: W

Next-Gen Performance for Future Drones

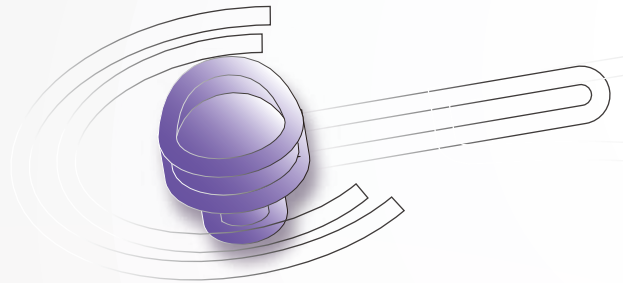

FUKUTA®

富田電機股份有限公司
FUKUTA ELEC. & MACH. CO., LTD.

總公司 Headquarter / 銅鑼廠區 Tongluo Plant

台灣苗栗縣銅鑼鄉銅科六路 6 號
No. 6, Tongke 6th Road., Tongluo Township, Miaoli
County 366, Taiwan (R.O.C.)
Tel: 886-37-980799 Fax: 886-37-980709

豐工廠區 / 中區營業所

台灣台中市神岡區豐工南路 18 號
No.18, Fenggoing S. Rd., Shen Kang Dist., Taichung
City 429, Taiwan (R.O.C.)
Tel: 886-4-2515-9568 Fax: 886-4-2515-9538

豐洲廠區 FengZhou Plant

台灣台中市神岡區豐洲路 301 巷 2-1 號
No. 2-1, Ln. 301, Feng Chou Rd., Shen Kang
Dist., Taichung City 429, Taiwan (R.O.C.)
Tel: 886-4-2528-8833 Fax: 886-4-2528-3979

北區營業所

桃園市龜山區華亞二路29號2樓
Tel: 886-3-3272909 Fax: 886-3-3275158

南區營業所

台南市東區光明街 201 巷 1 號 1 樓
Tel: 886-6-2098-236 Fax: 886-6-2085-402

日本營業窓口 株式会社 YTK

〒556-0011 大阪府大阪市浪速区難波中 2-10-70
なんばパークスタワー 19 階
Tel: 81-06-7662-8687 Fax: 81-06-6777-7941



富田官網
Website



富田型錄
Catalogue